

Wrights



172 Wyke Road
Trowbridge BA14 7NU

Monthly Rental Of £1,000



Wrights Residential, 24 Fore Street, Trowbridge, BA14 8ER
Phone: 01225 755553, Email: enquiries@wrightsresidential.co.uk
www.wrightsresidential.co.uk

Well presented two bedroom property

PVCu double glazing

Utility room

First floor Jack and Jill style shower room

Gas central heating

Spacious open plan kitchen/living room

Downstairs W.C

Generous rear garden

This spacious and well presented two bedroom house is situated on the Hilperton side of Trowbridge. Features include a spacious open plan kitchen/living room, utility room, downstairs cloakroom, a generous rear garden, gas central heating and PVCu double glazing. Available immediately, unfurnished.

The property comprises

Entrance Porch

With composite front door and radiator.

Lounge/Diner *17' 11" x 13' 5" (5.46m x 4.08m) approx*

With radiator, electric fire, stairs to the first floor and PVCu double glazed window to the front. Open plan into...

Kitchen *14' 3" x 13' 5" (4.34m x 4.08m) max*

With a range of eye level and base units, worktops with tiled splash backs, integrated electric oven and gas hob with extractor hood over, space for fridge/freezer, PVCu double glazed window to the rear and PVCu back door.

Utility room

With tall unit, worktop with space for washing machine under and PVCu double glazed window to the side.

Cloakroom

With W.C, hand basin with vanity unit, heated towel rail, wall mounted gas boiler, extractor fan and obscured PVCu double glazed window to the rear.

First Floor

Landing

With doors to both bedrooms.

Bedroom 1 *8' 9" x 9' 1" (2.66m x 2.78m) approx*

With radiator, built in wardrobe and PVCu double glazed window to the rear.

Bedroom 2 *6' 1" x 13' 5" (1.85m x 4.08m) approx*

With radiator and PVCu double glazed window to the front.

"Jack and Jill" shower room

With white suite comprising quadrant shower enclosure with mains shower, W.C and hand basin with vanity unit, heated towel rail and extractor fan.

Externally

The property offers a generous rear garden which is mainly laid to lawn with a patio seating area. To the front there is on road parking (non allocated).



Ground Floor

Approx. 48.1 sq. metres (518.0 sq. feet)

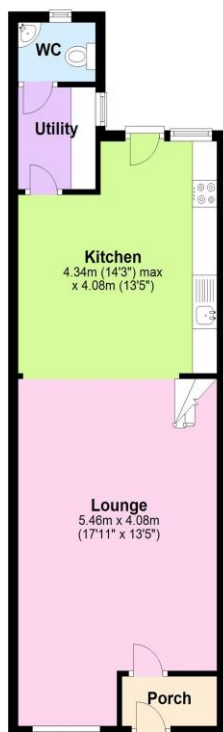

First Floor

Approx. 26.5 sq. metres (285.0 sq. feet)

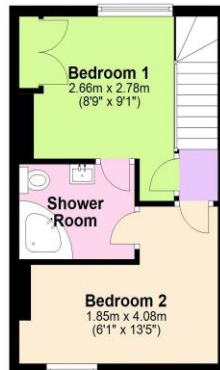

Total area: approx. 74.6 sq. metres (803.0 sq. feet)